

FEATURES

- SUPER LOW ESR AT HIGH FREQUENCY
- WIDE TEMPERATURE RANGE TO + 125°C
- 2,000 HOUR MINIMUM LIFE
- VERY HIGH RIPPLE CURRENT
- SOLVENT RESISTANT



PART NUMBERING

Part Number Example: MXCPB-016/101M10X10TR13FG									
MXCPB	-	016	/	101	M	10X10.5	TR	13	F
Type		Rated DC Voltage		Capacitance Code (μF)*	Tolerance Code	Size	Package Code**	Reel Size	RoHs Compliant
* Capacitance Code: First two digits represent significant figure, third digit represents multiplier (number of zeros).									
** Package Code: TR = Tape & Reel.									

SPECIFICATIONS

ITEMS		CHARACTERISTICS				
VOLTAGE RANGE				6.3	10	16
SURGE VOLTAGE		ROOM TEMPERATURE		8.2	13	20
TEMPERATURE RANGE				-55 ~ +125°C		
CAPACITANCE RANGE				33~1000μF		
CAPACITANCE TOLERANCE		@ 120Hz 20°C		M (+-20%)		
DISSIPATION FACTOR %		@ 120Hz 20°C		18	16	14
DC LEAKAGE CURRENT		(μA) AFTER 2 MINUTES		0.2 CV OR 100, WHICHEVER IS GREATER		
TEMPERATURE CHARACTERISTICS IMPEDANCE RATIO		@ 120Hz & 20°C		-55°C	Z/Z 20°C	0.75 TO 1.25
				125°C	Z/Z 20°C	
LOAD LIFE		@ 125°C RATED VOLTAGE AND RATED RIPPLE CURRENT		TEST		D 6.3=1500Hrs, D 8>= 2000Hrs
				ΔC/C		WITHIN +-30% OF INITIAL MEASURED VALUE
				DF		LESS THAN 200% OF SPECIFIED VALUE
				ESR		LESS THAN 200% OF SPECIFIED VALUE
				LC		LESS THAN SPECIFIED VALUE

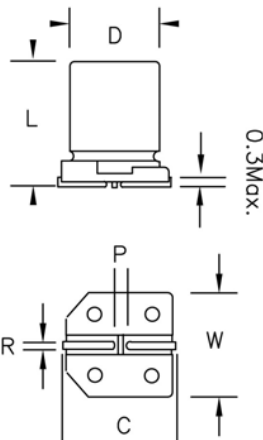

SIZE D X L	D	L MAX	W +0.2	C +0.2	R	P
6.3x6	6.3	6.3	6.6	7.3	0.5~0.8	2.2
6.3x7.7		8				
8 X10.5	8	10.8	8.3	9	0.7~1.0	3.2
10 X10.5	10	10.8	10.3	11	1.0~1.4	4.6

STANDARD PRODUCT TABLE (dØ X L(mm)), ESR & RIPPLE CURRENT

(µF)	6.3VDC			10VDC			16VDC		
33							6.3x6	54	640
47				6.3x6	40	850	6.3x7.7	45	830
68				6.3x6	40	850			
100	6.3x6	36	920	6.3x7.7	35	1020	8X10.5	22	1300
150	6.3x6	36	920				10X10.5	20	1650
220	6.3x7.7	32	1140						
330				8X10.5	18	1580			
560	8X10.5	16	1780	10X10.5	18	2060			
1000	10X10.5	15	2200						

ESR m Ω @ 100KHz 20°C
RIPPLE CURRENT mA @ 100KHz 125°C